



LIFTING POINTS

Quality, Reliability & Innovation



Super Point

Pivots to 230°, rotates through 360° due to its unique ball bearing design.
 Manufactured from forged alloy steel, quenched and tempered.
 Tested in accordance with EN1677-4.
 Certified by DGVV GS-OA 15-04.
 Load rated parts are 100% magnaflux crack detected.
 Individual forged parts and batch code links to Test Certificate sheet.
 Bolts are Metric thread.

Proof tested to 2.5 times the WLL.
 Fatigue rated to 20,000 cycles at 1.5 times the WLL.
 All YOKE Lifting points meet or exceed all the requirements of ASME B30.26.
 Easy to attach or dismantle due to the forged hexagon shaped body of the Super Point
 Capable of rotating under load.
 Do not turn continuously in 90 degree direction at full load.

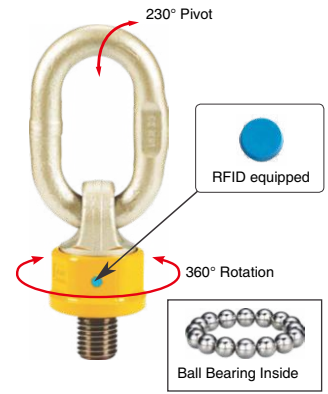

Product Code	WLL		Thread Version			Dimensions								Torque in		N.W.
	Tonnes	Kg	M	E	Pitch	A	B	C	D	F	G	K	H	Nm	Kg	
YKLPB10	*0.5	1	M10	18	1.5	35	53	48	13	101	36.5	34	20.5	10-40	0.4	
YKLPB12	*0.7	1.4	M12	18	1.75	35	53	48	13	101	36.5	34	20.5	15-40	0.4	
YKLPB16	*1.4	2.8	M16	24	2	35	53	48	13	101	36.5	34	20.5	45-130	0.5	
YKLPB20	*2.5	5	M20	30	2.5	35	59	68	16	127	52	46	28	100-170	1.0	
YKLPB24	*4	8	M24	30	3	40	73	75	19	148	57	50	34.5	190-280	1.5	
YKLPB30	*8	12	M30	45	3.5	50	95	106	22	201	81	75	48	270-600	3.7	
YKLPB36	*10	15	M36	50	4	50	95	106	22	201	81	75	48	270-600	3.8	
YKLPB42	*12.5	15	M42	63	4.5	50	95	106	22	201	81	75	48	270-700	4.0	
YKLPB48	*12.5	15	M48	72	5	50	95	106	22	201	81	75	48	270-700	4.4	
YKLPB56	*18	25	M56	78	5.5	70	129	127	32	256	104	95	58	350-900	8.1	

*Working load displayed on the lifting point

Key Eye Point

Rotates through 360° adjustable in the direction of the load.
 Manufactured from alloy steel, quenched and tempered.
 Tested in accordance with EN1677-1.
 Load rated parts are 100% magnaflux crack detected.
 Individual forged parts and cap screw are traceable to Test Certification.

Bolts are Metric thread.
 Proof tested to 2.5 times the WLL.
 Fatigue rated to 20,000 cycles at 1.5 times the WLL.
 All YOKE Lifting points meet or exceed all the requirements of ASME B30.26.
 Quick and simple assembly, just a tapped hole



Product Code	WLL		Thread Version			Dimensions								Torque in		N.W.
	Tonnes	Kg	M	E	Pitch	A	B	C	D	F	G	S	W	Nm	Kg	
YKLPK08	*0.3	1	M8	12	1.25	36	25	8	9	25	24	6	44	10	0.1	
YKLPK10	*0.4	1	M10	15	1.5	36	25	8	9	25	24	6	44	10	0.1	
YKLPK12	*0.75	2	M12	18	1.75	45	30	10	11	33	30	8	52	10	0.2	
YKLPK16	*1.5	4	M16	24	2	52	35	14	13	35	34	10	61	30	0.3	
YKLPK20	*2.3	6	M20	30	2.5	60	40	16	15	44	37	12	70	70	0.6	
YKLPK24	*3.2	8	M24	36	3	72	48	19	18	52	47	14	84	150	1.0	
YKLPK30	*4.5	12	M30	45	3.5	90	60	24	22	60	59	17	105	350	1.8	

*Working load displayed on the lifting point

CAUTION! Always read the instruction manual before use.
 Always wear the correct safety gear.

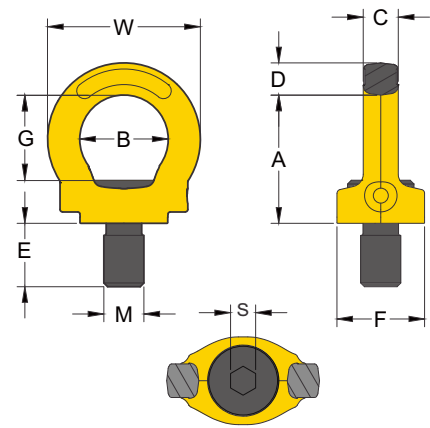

Factor of Safety 4:1



LIFTING POINTS

Quality, Reliability & Innovation



Lifting Point

Rotates through 360° and pivot 90°.
 Manufactured from alloy steel, quenched and tempered.
 Tested in accordance with EN1677-1.
 Certified by DGVV GS-OA 15-04.
 Load rated parts are 100% magnaflux crack detected.
 Individual forged parts and cap screw are traceable to Test Certification.

Bolts are Metric thread.
 Proof tested to 2.5 times the WLL.
 Fatigue rated to 20,000 cycles at 1.5 times the WLL.
 All YOKE Lifting points meet or exceed all the requirements of ASME B30.26.
 Quick and simple assembly, just a tapped hole is required.

Product Code	WLL		Thread Version			Dimensions										Torque		N.W.
	Tonnes	kg	M	E	Pitch	A	B	C	D	F	G	H	S	SW	Nm	Kg		
YKLPS08	*0.3	0.3	M8	11	1.25	30	35	35	10	85	55	29	6	13	30	0.2		
YKLPS10	*0.63	0.63	M10	16	1.5	30	35	36	10	85	55	29	6	17	60	0.3		
YKLPS12	*1	1	M12	18	1.75	33	37	44	14	98	57	36	8	19	100	0.5		
YKLPS14	*1.2	1.2	M14	21	2	33	37	45	14	98	57	36	10	22	120	0.5		
YKLPS16	*1.5	1.5	M16	24	2	33	37	46	14	98	57	36	10	24	150	0.5		
YKLPS18	*2	2	M18	26	2	50	54	57	17	140	82	44	12	30	200	1.3		
YKLPS20	*2.5	2.5	M20	30	2.5	50	54	57	17	140	82	44	12	30	250	1.3		
YKLPS24	*4	4	M24	36	3	50	54	59	17	140	82	44	14	36	400	1.4		
YKLPS27	*4	4	M27	38	3	60	65	79	23	170	99	62	17	41	400	2.8		
YKLPS30	*5	5	M30	48	3.5	60	65	81	23	170	99	62	17	46	500	3.1		
YKLPS36	*7	7	M36	54	4	60	65	88	178	23	178	99	22	55	700	3.3		
YKLPS42	*10	10	M42	72	4.5	77	85	104	27	225	124	78	24	65	1000	6.3		
YKLPS48	*20	20	M48	72	5	95	104	120	36	259	158	90	27	75	2000	11.6		

*Working load displayed on the lifting point

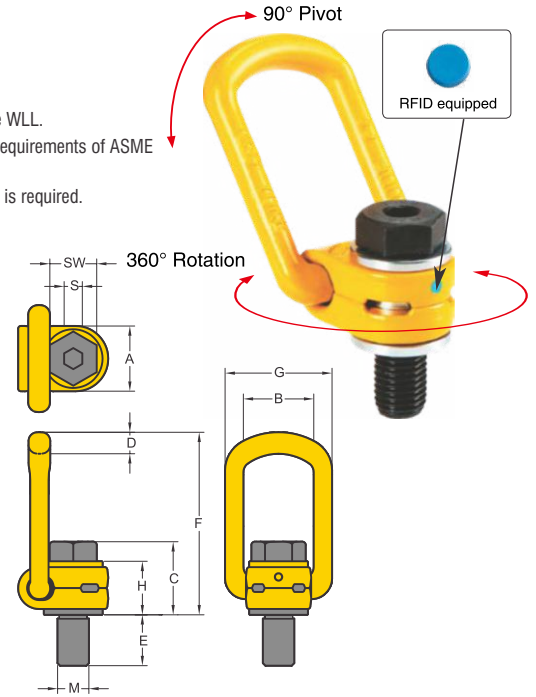

Lifting Point - Extended Bolt

Rotates through 360° and pivots 90°.
 Manufactured from alloy steel, quenched and tempered.
 Tested in accordance with EN1677-1.
 Load rated parts are 100% magnaflux crack detected.
 Individual forged parts and cap screw are traceable to Test Certification.

Bolts are Metric thread.
 Proof tested to 2.5 times the WLL.
 Fatigue rated to 20,000 cycles at 1.5 times the WLL.
 All YOKE Lifting points meet or exceed all the requirements of ASME B30.26.
 Quick and simple assembly, just a tapped hole is required.

Product Code	WLL		Thread Version			Dimensions										Torque		N.W.
	Tonnes	kg	M	E	Pitch	A	B	C	D	F	G	H	S	SW	Nm	Kg		
YKLPSXB16-149	*1.5	1.5	M16	149	2	33	37	46	14	98	57	36	10	24	150	0.7		
YKLPSXB20-186	*2.5	2.5	M20	186	3	50	54	57	17	140	82	44	12	30	250	1.7		
YKLPSXB24-221	*4.0	4.0	M24	221	3	50	54	59	17	140	82	44	14	36	400	2.1		

*Working load displayed on the lifting point

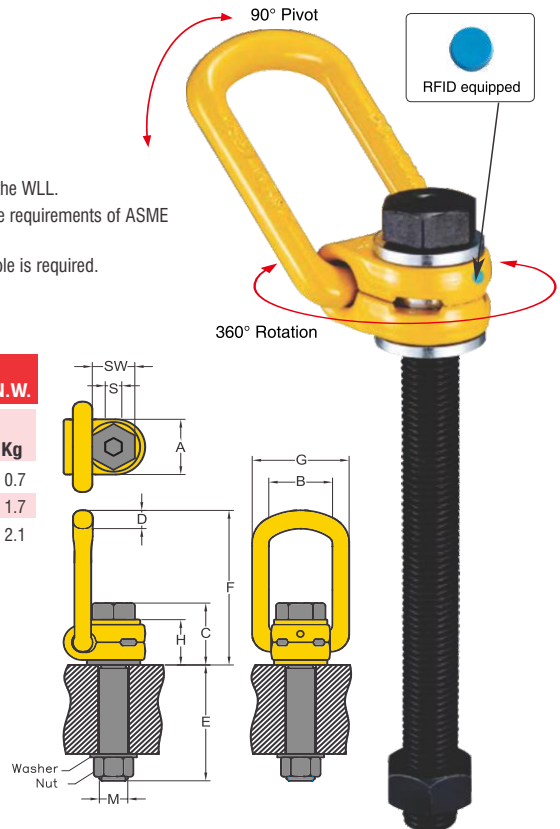

CAUTION!

Always read the instruction manual before use.
 Always wear the correct safety gear.

